



# ROOM HIRE PACK



"I FEEL LIKE WHEN I AM HERE I HOLD THE WHOLE WORLD IN MY PALM. I CAN DO ANYTHING."



## WELCOME TO THE PAN CENTRE, VAUXHALL

Pan Intercultural Arts is a charity harnessing the power of the arts to drive social change and integration. We work with refugees, survivors of trafficking, and young people from underserved communities, empowering them to rediscover their voices and shape brighter futures for themselves and society as a whole. Their mental health and wellbeing are at the core of our work.

In January 2026, Pan opened its first dedicated centre, in Vauxhall. With a large workshop studio, community space, kitchen, and several smaller rooms, the centre has been designed to support creativity, collaboration, and connection.

We are proud to offer this space at affordable rates to like-minded charities and organisations, with every booking income going straight into supporting our vital work with marginalised and vulnerable people.





## THE WELCOME AREA

As you enter our Pan Centre you enter our Welcome Area, with is a 5.5m long table which can easily seat 20, a sofa, soft seating and a space for flexible working. The space includes a projector onto one of the clear walls.

Both the Pan office and kitchen are an extension of this room.

This can be used for private dining, meetings, gatherings, talks or as a welcome point if you're hiring the whole space.

**Hire this space from £75 per hour.**





## WORKSHOP SPACE

This is our largest room where we run our weekly projects. It can be used for rehearsals, performances, events and talks.

- Up to 100 seated and/or standing
- Recommended up to 30 for workshops & classes
- White wall or pull down screen for any projection use
- Connected to a Green Room which is included in hire fee
- 70 x stackable chairs available

**Hire this space from £75 per hour.**





## COMMUNITY SPACE

Our open area is as adaptable as it is welcoming! Can be used for community events, talks and gatherings.

There is significant wall space which can be used for exhibition and display.

As you enter the room, we have an artist commission, reimagining Pan's 40 year history as a colourful river.

- Up to 80 seated and/or standing
- If standing, sofa and soft seating arrangements available
- Additional moveable wallspace and plinths for exhibitions available
- Open space

**Hire this space from £75 per hour.**





## MESSY ROOM

Our room where mess is encouraged!

This space is perfect for art classes and making workshops.

Up to 20 seated round an art table.

**Hire this space from £60 per hour.**

## CHARITY OFFICE SPACE

We are looking for a charity to hire this room longer term as their office with space for 8-10 people to work from, including access to our facilities and discounted room hire rates.

Minimum term: 6 months





## HOT DESKING AT PAN

We also offer a relaxed and welcoming workspace for charities, social enterprises, and creatives to work alongside one another in a spacious community arts centre with great facilities.

Join our tight knit community of creatives using the space knowing that your investment is fuelling arts for social change.

We have up to 8 desks available Mon - Thu from 10am - 6pm with prices starting from £15.

Includes:

- Unlimited wifi use
- Unlimited hot drinks for £5 per day
- Use of our 'Quiet Space' for private meetings
- Use of our welcome area and community space if a change of scenery is needed!





## ACCOMPANYING ROOMS

### Kitchen

With a dishwasher, fridge/freezer, oven, hob, microwave and kettle. It is not a commercial kitchen but can be used as part of your hire for a small additional fee.

### Quiet Space

This space is included within your hire and is for any moments where you need room to breathe and to have some privacy.

### Children's Room

This space (first picture) can be hired for children's use and has a selection of books, toys and crafts available. Baby changing facilities available.

### Meeting Room

Can seat up to 12 round a large table (until it is hired longer term).

### Green Room

Included in the hire fee for the workshop area - this can be used as a small breakout space and also for performances - there are doors into the workshop space and main area.



The Children's Room



The Kitchen



The Quiet Space



## ADDITIONAL INFO & BOOKING

- Ground floor, accessible with blue badge parking
- Discounted rates for Lambeth Community.
- Wifi available throughout the space, with recycling points and ample plug sockets.
- Kitchen equipped with fridge, microwave, kettle, hob and oven (use of kitchen has a small additional fee)
- Portable PA system & projector in both welcome and workshop spaces (small additional fee)

**To receive a quote for your hire please email [post@pan-arts.net](mailto:post@pan-arts.net) with**

- date and time needed
  - room choices
  - requirement details
  - if you are from Lambeth and/or a charity
  - any further info which would be useful
- and we will get back to you soon!



**The Community Area/ Hot Desking**



**The Archive Room**



**The Quiet Space hosting a podcast**



# PRICES

All charities will receive a 50% discount on room hire fees (not including hot desking)

Activity	Time	Space			
		Entire Space	Workshop Space (Green room included)	Welcome Area or Community Space	Messy Room (Art Room) or Board Room
Monday - Friday (office hours 10am - 6pm)	Hourly (for hires under 4 hrs)	on request	£75	£75	£60
	Full Day	£1,200	£525	£525	£400
	Evening	£1,000	£400	£400	£300
	Work Week	£4,800	£2000 (only available on school holidays)	£2,000	£1,500
Weekend	Half Day	on request	£520	£520	£400
	Full Day		£800	£800	£600
Hot desking	Half Day Pass	£15	Up to 4 hours between 10.30am-6.30pm		
	Day Pass	£25	8 hours, 10am-6pm		
	Weekly Pass	£90	4 days Monday - Thursday, 10am-6pm		
	Pan Membership Pass	£350	By Getting a Pan Pass you receive: - A dedicated desk Mon - Thu every week - 20% discount on all room hires and priority room hire - Unlimited tea and coffee included - Printing & Stationary - Mail Handling & Reception		

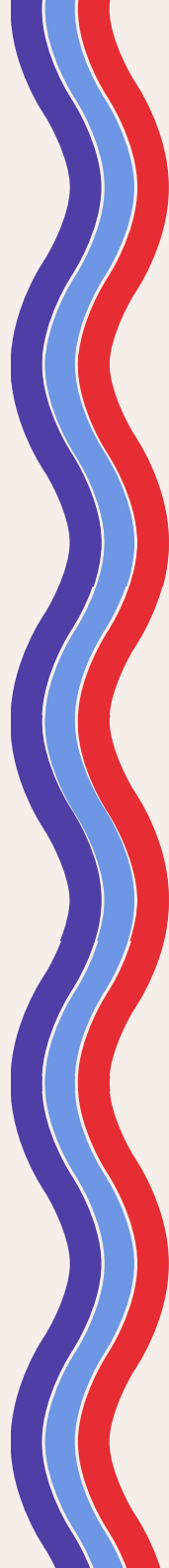



# FLOORPLAN

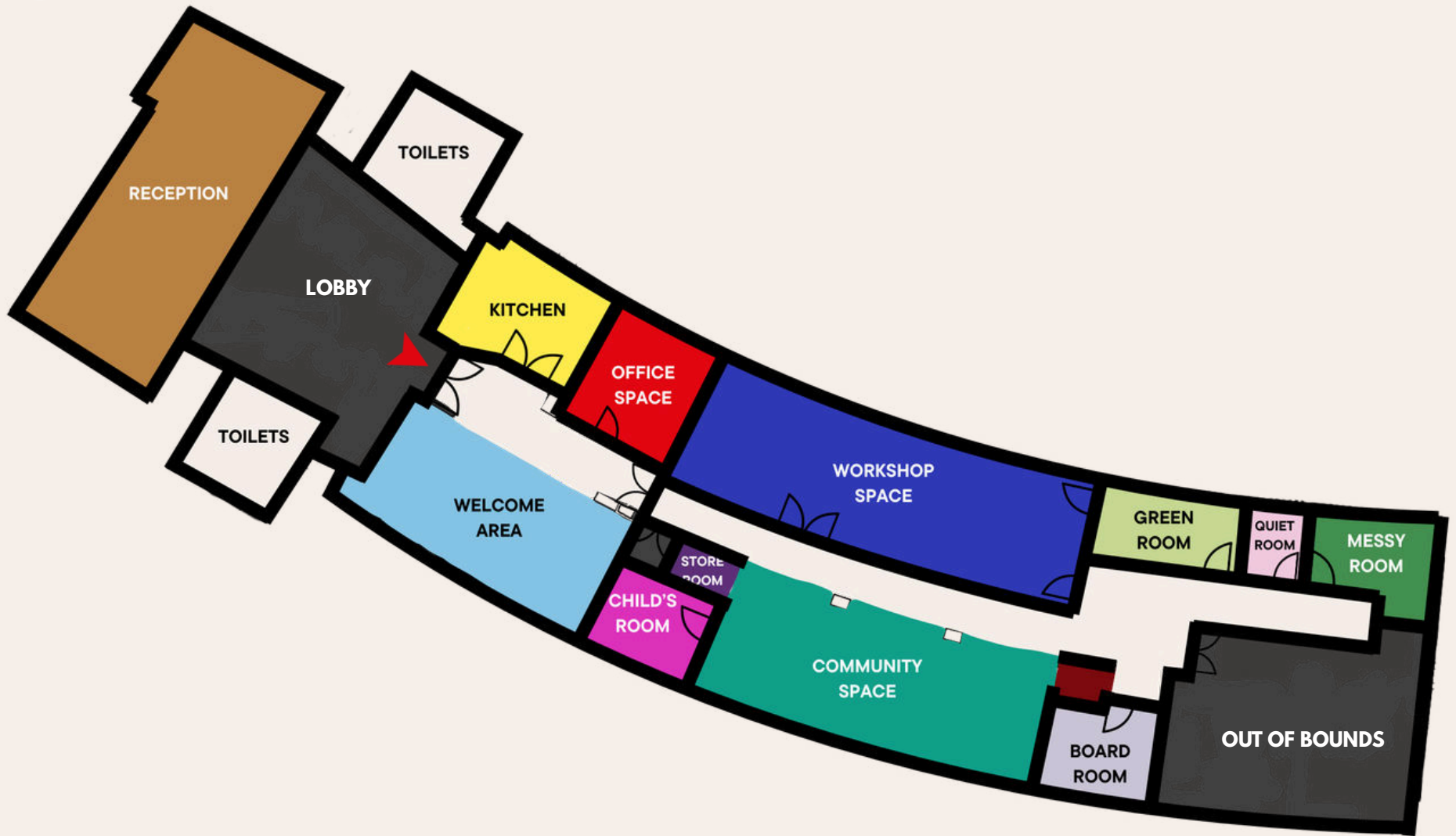



## HOW TO GET HERE

By Train: Vauxhall Station (Victoria Line & National Rail Services) is the nearest – about a 4-minute walk.

By Bus: Several buses stop nearby, including routes 2, 36, 185, 156, 344, 436, 77 and 360.

By Car: Limited parking is available at Camelford House. We recommend using public transport where possible.

Once you arrive at Camelford House, sign in at reception - you and your guests' names will be given prior to arrival, we are situated on the ground floor.

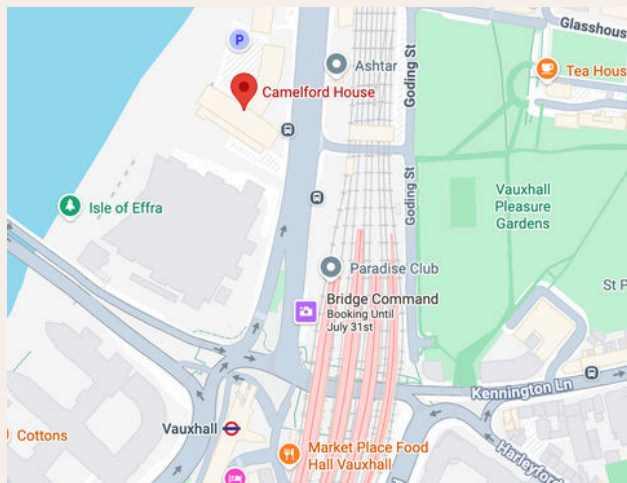

# THE WELCOME SPACE - IN USE



# THE WORKSHOP SPACE - IN USE



# THE COMMUNITY SPACE - IN USE



# THE COMMUNITY SPACE - EXHIBITION READY





## ABOUT PAN

**Our participants are at the heart of everything we do.**

We work with groups of people who are often not heard in society, those who may feel lost, uprooted, anxious and unsafe. Our aim is to give them opportunities to build their self confidence and develop their sense of self worth. We work with people from all cultures and religions to encourage a world where we listen to, understand and respect each other's lives and experiences, discovering the possibilities of our rich society.

Not only do their ideas, views and needs steer all our activities, the majority of our artist-facilitators were once participants in our projects and bring vital lived experience into the work.

In the year **September 2024 to August 2025 we achieved:**

-  **374** WORKSHOPS
-  **615** PARTICIPANTS
-  **11** ONGOING PROJECTS
-  **8488** PARTICIPANT HOURS





## WHY PAN'S WORK IS NEEDED

Trauma limits more than opportunity — it limits imagination. When someone has lived in survival mode, it becomes almost impossible to picture a different future: a job, an education, a life filled with hope and possibility. Pan exists to reignite that imagination.

Through the arts, we help people move beyond experiences of trauma to rebuild confidence, reclaim their voice, and rediscover their potential. As one participant put it, **“I was broken in pieces — now I can stand on my own feet.”**

Pan works with people whose lives have been shaped by complex and overlapping challenges — from displacement and discrimination to poverty and poor mental health. 94% of our participants identify as Black, South Asian, Middle Eastern, East or Southeast Asian, or Mixed heritage. Each person's story is unique, and our approach is rooted in meeting them where they are, using creativity as a tool for healing, empowerment, and social change.

Employability becomes a natural outcome of this process: many progress into education, training, or full-time work, and over 85% of our paid artist-facilitators are former participants themselves.

By transforming trauma into creativity and isolation into community, Pan creates lasting personal and social change — unlocking potential that benefits individuals, communities, and society as a whole.

**Whether you are hiring for an event, running a rehearsal or using our hot desks, you know that your investment is going straight into supporting those who need it the most.**





# THANK YOU FOR YOUR INTEREST



Pan Intercultural Arts is a limited company No. 2051893 and a registered charity No. 295324